

INGREDIENTS

- 2 contrasting Charm squares

INSTRUCTIONS

- 1 Place Charm squares right sides together.
- 2 Sew a scant 1/4" seam from each of two opposite sides.
- 3 Cut apart at the center - 2" from either seam. Press units towards the darker fabric.

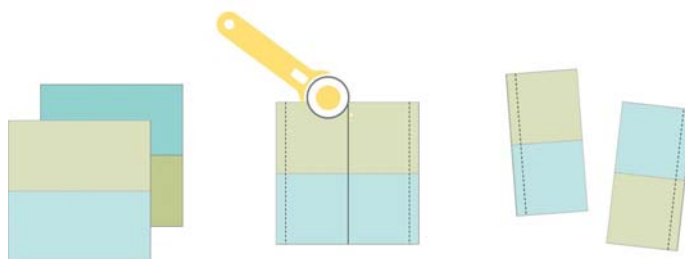
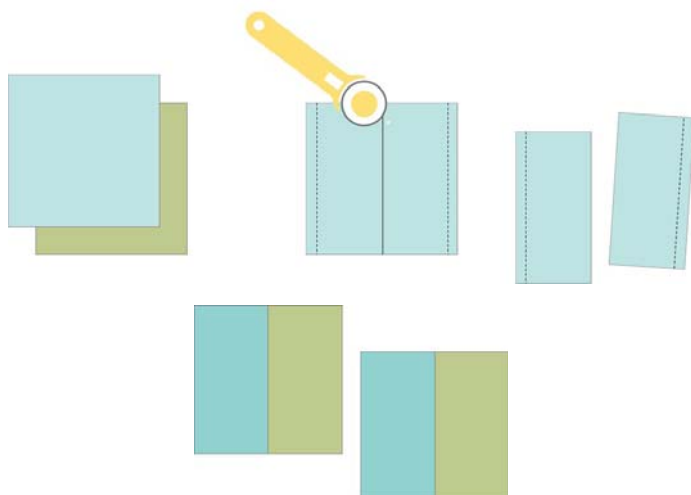

- 4 Flip units so that prints are opposite one another. Nest seams and pin together,
- 5 Sew scant 1/4" seam on each opposite side. Cut apart at the center - 2" from either seam.
- 6 Press towards the darker fabric.

YIELD

Two charm squares make (2) 4½" 4-patches.

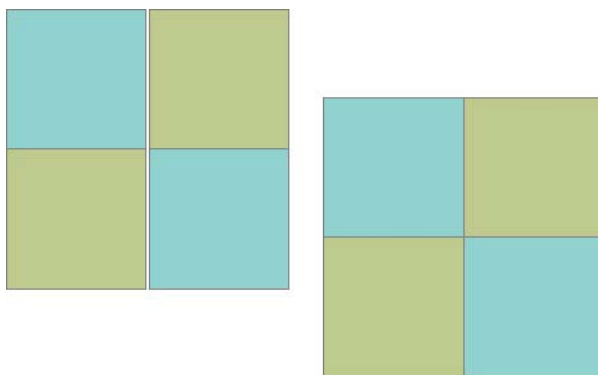

EASY

WWW.MODABAKESHOP.COM

CONNECT WITH US

modabakeshop.com
@modabakeshop

